



THE CITY OF NEW YORK
MANHATTAN COMMUNITY BOARD 3

59 East 4th Street - New York, NY 10003
Phone: (212) 533-5300 - Fax: (212) 533-3659
www.cb3manhattan.org - info@cb3manhattan.org

Gigi Li, Board Chair

Susan Stetzer, District Manager

Community Board 3 Liquor License Application Questionnaire

Please bring the following items to the meeting:

NOTE: ALL ITEMS MUST BE SUBMITTED FOR APPLICATION TO BE CONSIDERED.

- Photographs of the inside and outside of the premise.
- Schematics, floor plans or architectural drawings of the inside of the premise.
- A proposed food and or drink menu.
- Petition in support of proposed business or change in business with signatures from residential tenants at location and in buildings adjacent to, across the street from and behind proposed location. Petition must give proposed hours and method of operation. For example: restaurant, sports bar, combination restaurant/bar. (petition provided)
- Notice of proposed business to block or tenant association if one exists. You can find community groups and contact information on the CB 3 website: http://www.nyc.gov/html/mancb3/html/communitygroups/community_group_listings.shtml
- Photographs of proof of conspicuous posting of meeting with newspaper showing date.
- If applicant has been or is licensed anywhere in City, letter from applicable community board indicating history of complaints and other comments.

Check which you are applying for:

- new liquor license alteration of an existing liquor license corporate change

Check if either of these apply:

- sale of assets upgrade (change of class) of an existing liquor license

Today's Date: 08/27/2015

If applying for sale of assets, you must bring letter from current owner confirming that you are buying business or have the seller come with you to the meeting.

Is location currently licensed? Yes No Type of license: _____

If alteration, describe nature of alteration: _____

Previous or current use of the location: Previous use-Bistro/Restaurant/Bar

Corporation and trade name of current license: n/c

APPLICANT:

Premise address: 119th St Marks Place, New York, NY, 10003

Cross streets: 8th Street Btwn Ave A & 1st Ave

Name of applicant and all principals: Amadou Lamine Diene

Trade name (DBA): Le Delice LLC

PREMISE:

Type of building and number of floors: Mix Use Building - 1st floor and basement

Will any outside area or sidewalk cafe be used for the sale or consumption of alcoholic beverages? (includes roof & yard) Yes No If Yes, describe and show on diagram: _____

Does premise have a valid Certificate of Occupancy and all appropriate permits, including for any back or side yard use? Yes No What is maximum NUMBER of people permitted? 75

Do you plan to apply for Public Assembly permit? Yes No

What is the zoning designation (check zoning using map: <http://gis.nyc.gov/doitt/nycitymap/> - please give specific zoning designation, such as R8 or C2):

R8B

PROPOSED METHOD OF OPERATION:

Will any other business besides food or alcohol service be conducted at premise? Yes No

If yes, please describe what type: _____

What are the proposed days/hours of operation? (Specify days and hours each day and hours of outdoor space) Mon, Tues, & Wed: 5 p.m.-12 a.m.; Thurs-Fri: 5 p.m to 1 a.m.;
Saturday: 11 a.m. to 3 p.m & 5 p.m. to 1a.m.; Sunday: 11 a.m to 3pm & 5 p.m. to 12am

Number of tables? 10 Total number of seats? 24

How many stand-up bars/ bar seats are located on the premise? 1 Bar/15 seats

(A **stand up bar** is any bar or counter (whether with seating or not) over which a patron can order, pay for and receive an alcoholic beverage)

Describe all bars (length, shape and location): "U" shape, center right hand side, 10-12 feet

Does premise have a full kitchen Yes No?

Does it have a food preparation area? Yes No (If any, show on diagram)

Is food available for sale? Yes No If yes, describe type of food and submit a menu

French Mediterranean cuisine

What are the hours kitchen will be open? M-W(5-10) T-F(5-11) Sa(11-3/5-11) Su(11-3/5-10)

Will a manager or principal always be on site? Yes No If yes, which? Amadou L Diene

How many employees will there be? 2 to 4

Do you have or plan to install French doors accordion doors or windows?

Will there be TVs/monitors? Yes No (If Yes, how many?) 1

Will premise have music? Yes No

If Yes, what type of music? Live musician DJ Juke box Tapes/CDs/iPod

If other type, please describe _____

What will be the music volume? Background (quiet) Entertainment level

Please describe your sound system: 4 to 6 ceiling speakers

Will you host any promoted events, scheduled performances or any event at which a cover fee is charged? If Yes, what type of events or performances are proposed and how often? NO

How do you plan to manage vehicular traffic and crowds on the sidewalk caused by your establishment? Please attach plans. (Please do not answer "we do not anticipate congestion.")

Will there be security personnel? Yes No (If Yes, how many and when) _____
Except on major holiday event such as New Year Eve

How do you plan to manage noise inside and outside your business so neighbors will not be affected? Please attach plans.

Do you have sound proofing installed? Yes No
If not, do you plan to install sound-proofing? Yes No

APPLICANT HISTORY:

Has this corporation or any principal been licensed previously? Yes No

If yes, please indicate name of establishment: _____

Address: _____ Community Board # _____

Dates of operation: _____

If you answered "Yes" to the above question, please provide a letter from the community board indicating history of complaints or other comments.

Has any principal had work experience similar to the proposed business? Yes No If Yes, please attach explanation of experience or resume.

Does any principal have other businesses in this area? Yes No If Yes, please give trade name and describe type of business _____

Has any principal had SLA reports or action within the past 3 years? Yes No If Yes, attach list of violations and dates of violations and outcomes, if any.

Attach a separate diagram that indicates the location (**name and address**) and total number of establishments selling/serving beer, wine (B/W) or liquor (OP) for 2 blocks in each direction. Please indicate whether establishments have On-Premise (OP) licenses. Please label streets and avenues and identify your location. Use letters to indicate **Bar, Restaurant**, etc. The diagram must be submitted with the questionnaire to the Community Board before the meeting.

LOCATION:

How many licensed establishments are within 1 block? 10+

How many On-Premise (OP) liquor licenses are within 500 feet? 5+

Is premise within 200 feet of any school or place of worship? Yes No

COMMUNITY OUTREACH:

Please see the Community Board website to find block associations or tenant associations in the immediate vicinity of your location for community outreach. Applicants are encouraged to reach out to community groups. Also use provided petitions, which clearly state the name, address, license for which you are applying, and the hours and method of operation of your establishment at the top of each page. (Attach additional sheets of paper as necessary).

We are including the following questions to be able to prepare stipulations and have the meeting be faster and more efficient. Please answer per your business plan; do not plan to negotiate at the meeting.

1. I will close any front or rear facade doors and windows at 10:00 P.M. every night or during any amplified performances, including but not limited to DJs, live music and live nonmusical performances.
2. I will not have DJs, live music, promoted events, any event at which a cover fee is charged, scheduled performances, more than ____ DJs/ promoted events per ____, more than 10 private parties per year.
3. I will play ambient recorded background music only.
4. I will not apply for an alteration to the method of operation agreed to by this stipulation without first coming before CB 3.
5. I will not seek a change in class to a full on-premise liquor license without first obtaining approval from CB 3.
6. I will not participate in pub crawls or have party buses come to my establishment.
7. I will not have a happy hour. I will have happy hour and it will end by 5 to 7.
8. I will not have wait lines outside. There will be a staff person outside to monitor sidewalk crowds and ensure no loitering.
9. Residents may contact the manager/owner at the following phone number. Any complaints will be addressed immediately and I will revisit the above-stated method of operation if necessary in order to minimize my establishment's impact on my neighbors.

ATTENTION RESIDENTS & NEIGHBORS

LE DELICE LLC

Company/DBA Name and Contact Number for Questions

Plans to open a

WINE AND BRANDY ESTABLISHMENT, NO SIDEWALK CAFE OR BACKYARD GARDEN

(Please choose) Bar/Restaurant/Club and indicate if there will be a Sidewalk Café or Backyard Garden

at the following location

119 ST MARCKS PLACE, NEW YORK, NY, 1009

Building Number and Street Name (Address)

This establishment is seeking a license to serve

LIQUOR, WINE AND BEER

Beer & Wine or Beer/Wine & Liquor

There will be an opportunity for public comment on

Tuesday, September 1, 2015 at 6:30pm

Community Board 3 Office

59 East 4th Street (btwn 2nd Ave & Bowery)

Date/Time/Location

AMADOU L. DIENE phone: 917-388-0648 email: AMALDIENE@GMAIL.COM

Applicant Contact Information

At COMMUNITY BOARD 3

SLA & DCA Licensing Committee Meeting

info@cb3manhattan.org - www.cb3manhattan.org

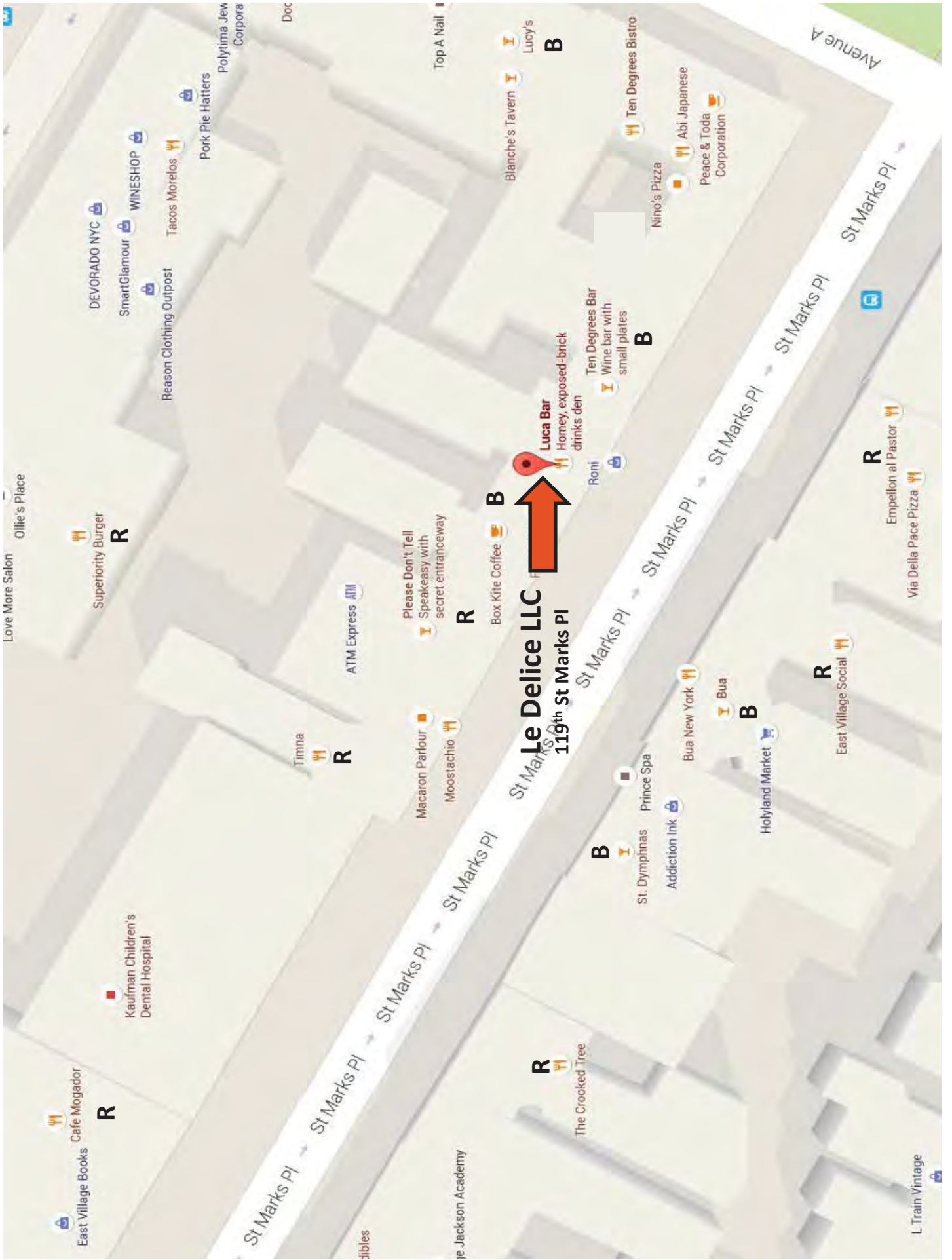

FIRST FLOOR

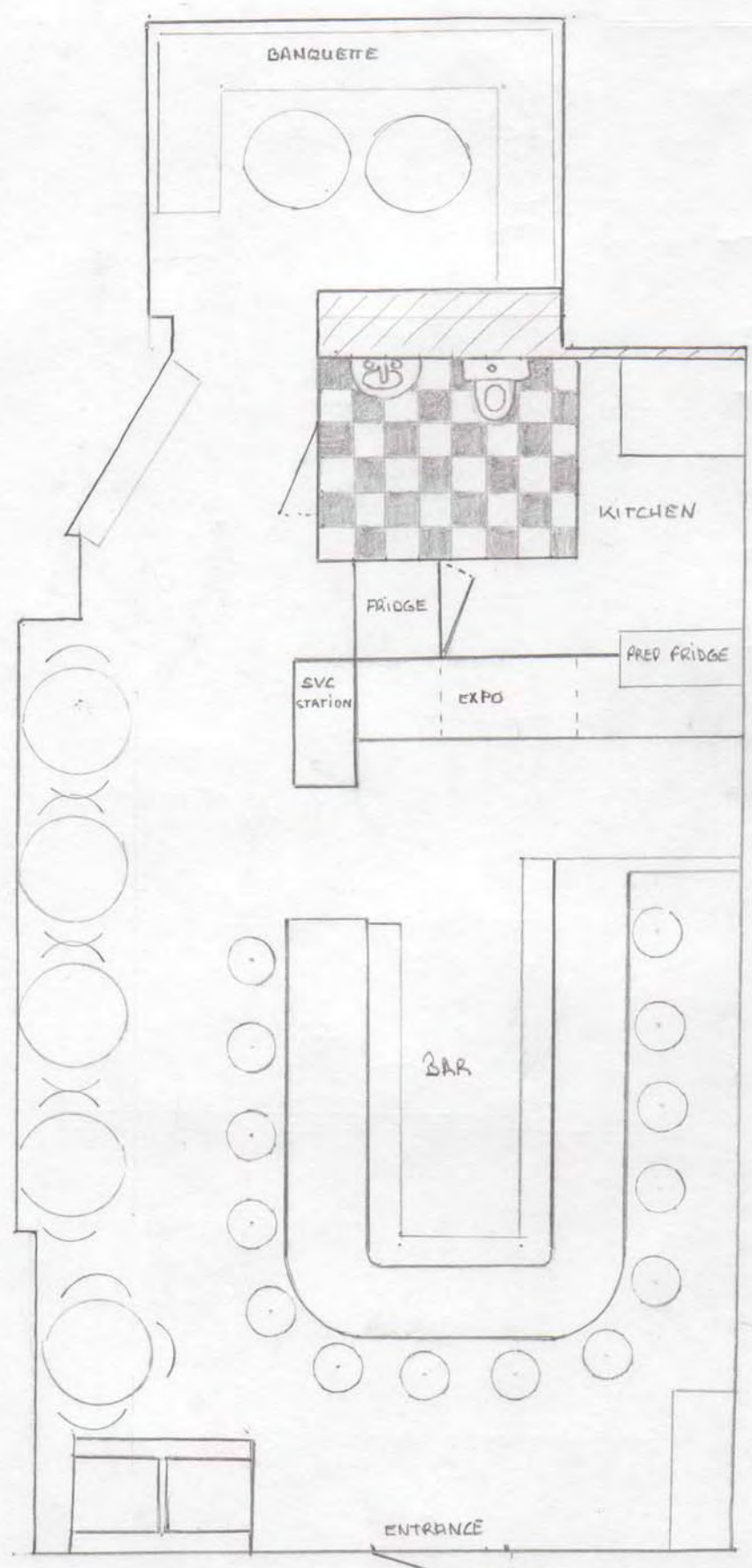

BASEMENT

GARDEN

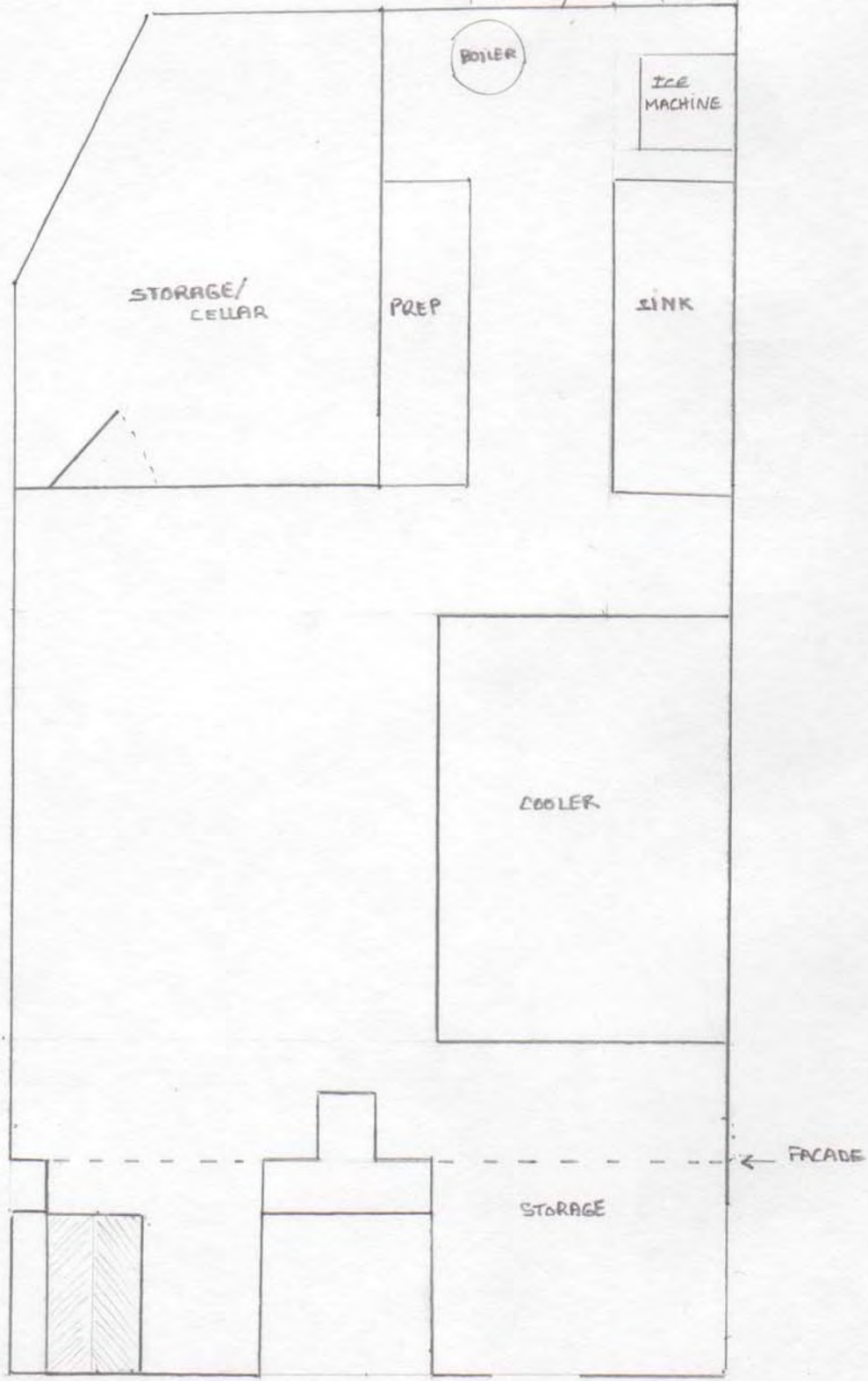

STAIRCASE
ENTRANCE

← FACADE

Petition to Support Proposed Liquor License

Date: 8/24/2015

The following undersigned residents of the area support the issuance of the following liquor license (indicate the type of license such as full-liquor or beer-wine) Full-liquor license

to the following applicant/establishment (company and/or trade name) Le Delice LLC

Address of premises: 119th St Marks Place











This business will be a: (circle) Bar Restaurant Other: _____

The hours of operation will be:

M-W (5pm-12am), T-F (5pm-1am), S (11am-3pm and 5pm-1am), S (11am-3pm and 5pm-12am)

PLEASE NOTE: Signatures should be from residents of building, adjoining buildings, and within 2-block area.

Other information regarding the license:

Name	Signature	Address
Lindsey Mathias		119 St Marks Pl #18
James Bingham		415 East 9 th St, #3
Mark Salfator		119 St Marks #1
Sean Acevedo		119 St. Marks Pl #15
Zac Merahn		119 St Marks Pl #6
Connor Scull		415 St Marks, #1 #6
Timothée de Chateaufort		126 Saint Marks Pl #10
Nicholas Mason		119 Saint Marks Pl Apt 7
Michael Amador		115 Saint Marks Pl Apt 12
Melody Althart		415 East 9 th St, Apt 3
JUAN JUDARCA		43 St Marks Pl Apt 2

Le Delice, LLC
119 St. Marks Place
Crowd, Traffic & Noise Plans

We plan to manage vehicular traffic and sidewalk crowds as follows:

All customers will wait inside the restaurant before being seated. There will be no outdoor seating, no waiting area outside, and there will not be a place for them to congregate or loiter outside the restaurant. As for vehicle traffic, we will provide customers with a list of available off street parking options during the booking/reservation process, and encourage them to use those resources.

We plan to manage interior/exterior noise as follows:

We will install interior soundproofing to minimize the impact of noise coming from our restaurant. We will only play ambient background music. Exterior noise will be minimized by not having customers wait outside or congregate outside.